

VENTILATION



Clean Air Supply

Remove Up to 99.99% of Harmful Particles on Pre-Filter with UVnano

UVnano™
UVnano is a compound word of UV (ultraviolet) LED which reduces harmful bacteria, and nanometer which is the UV wavelength unit.

UVnano Technology Applied

It Prevents 99.99 % of Bacteria and Viruses from Growing

Easy Filter Maintenance

Via the one-touch button, the user can open the access door at the bottom of the unit, pull down the heat exchanger to change the filters. It is easy and simple without the need for any additional tools.

One Touch Button

Filter Handle

After pressing the one-touch button, unhook the safety hooks that holds door from failing to fully open the door.

Hold the filter handle and pull it out down.

Smart Control

① Dual Laser Fine Dust Sensor

Two fine dust sensors monitor the incoming air and the supplied air to the room in real time to ensure that clean air is always supplied.

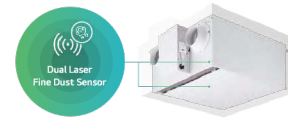

When the measured dust concentration in the air supplied to the room is higher than the pre-set value, a notification or text message will be sent out for filter replacement.

* Wi-Fi Modem is Optional.

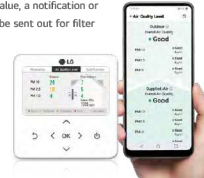

② CO₂ Monitoring

The embedded CO₂ sensor monitors the carbon dioxide concentration in the room in real time and automatically controls the ventilation rate.



The system monitors the CO₂ concentration in the room and adjusts the ventilation rate accordingly. When the CO₂ concentration is high, it increases the ventilation rate, and automatically reduces it when the concentration is low.

* Wi-Fi Modem is Optional.



* CO₂ Sensor is Embedded

③ Control ERV Anytime, Anywhere

| Wired Remote Control | Mobile | Third-Party Compatibility |
|--------------------------------------------------------------------------------------------------------------------------------------------------------------------------------|----------------------------------------------------------------|---------------------------------------------------------------|
| | | |
| <ul style="list-style-type: none"> Indoor CO₂ concentration Dust concentration in the supply air Dust concentration in outdoor air | Check and control the Indoor air conditioner anytime, anywhere | With the dry contact connected, Modbus protocol is available. |

* To use 3rd party wall pad, please contact Sales Engineer.

④ Filter Maintenance Alarm

The filter replacement notification and text message are sent when the fine dust concentration is higher than the pre-set point.

When Should the Filter be Replaced?

Replace the fine dust filter in ERV.

Vent
Replace the fine dust filter in ERV.
Bypass

Filter Good

LZ-H015GBA6 / LZ-H020GBA6



| MODEL | | | LZ-H015GBA6 | LZ-H020GBA6 |
|------------------------|---------------------------------------------|------------------------|-----------------------|-----------------------|
| Dimensions (W x H x D) | Body | mm | 640 x 320 x 640 | 640 x 320 x 640 |
| | Weight | kg | 23 | 23 |
| Power Supply | | Ø / V / Hz | 1 / 230 / 50 | 1 / 230 / 50 |
| | Operating Step | | SH / H / L | SH / H / L |
| ERV Mode | Current | SH / H / L A | 0.43 / 0.38 / 0.23 | 0.59 / 0.51 / 0.26 |
| | Power Input | SH / H / L W | 56 / 49 / 26 | 79 / 71 / 30 |
| | Air Flow | SH / H / L CMH | 150 / 150 / 80 | 200 / 200 / 100 |
| | External Static Pressure | SH / H / L Pa | 100 / 70 / 50 | 100 / 70 / 50 |
| | Heating Efficiency | Heating SH / H / L (%) | 85 | 82 |
| | Temperature Exchange Efficiency | Heating SH / H / L (%) | 80 / 80 / 84 | 78 / 78 / 82 |
| | | Cooling SH / H / L (%) | 74 / 74 / 83 | 70 / 70 / 81 |
| | Enthalpy Exchange Efficiency | Heating SH / H / L (%) | 79 / 79 / 83 | 75 / 75 / 81 |
| | | Cooling SH / H / L (%) | 74 / 74 / 80 | 68 / 68 / 76 |
| | Energy Label | Ax to G Scale | A | A |
| Sound Power Level | SH / H / L | dB(A) | 53 / 51 / 45 | 55 / 53 / 46 |
| | SH / H / L | dB(A) | 28 / 26 / 21 | 30 / 28 / 22 |
| Bypass Mode | Current | SH / H / L A | 0.45 / 0.40 / 0.26 | 0.60 / 0.52 / 0.29 |
| | Power Input | SH / H / L W | 63 / 53 / 31 | 84 / 73 / 35 |
| Operation Range | Air Flow | SH / H / L CMH | 150 / 150 / 80 | 200 / 200 / 100 |
| | External Static Pressure | SH / H / L Pa | 100 / 70 / 50 | 100 / 70 / 50 |
| Duct Work | Outdoor Air Temperature / Relative Humidity | °C / % | -10 - 40 / 20 - 80 | -10 - 40 / 20 - 80 |
| | Qty | EA | 4 | 4 |
| Fan Motor | Supply Air Fan | RPM | 1,850 / 1,710 / 1,300 | 2,050 / 1,910 / 1,400 |
| | Exhaust Air Fan | RPM | 1,750 / 1,600 / 1,250 | 1,910 / 1,770 / 1,320 |
| Filters | Max. | RPM | 2,100 | 2100 |
| | Min. | RPM | 1,000 | 1,000 |
| | Grade ³⁾ | - | ePM, 95% | ePM, 95% |
| | Size (W x H x D) | mm | 278 x 276 x 50 | 278 x 276 x 50 |

Note:
 1. Cooling Capacity Test condition - Indoor temperature : 27°C DB, 19°C WB / Outdoor temperature : 35°C DB
 2. Heating Capacity Test condition - Indoor temperature : 20°C DB / Outdoor temperature : 7°C DB, 6°C WB
 3. Humidifying capacity is based on the following conditions - Indoor temperature : 20°C DB, 15°C WB / Outdoor temperature : 7°C DB, 6°C WB
 4. Cooling and heating capacities are based on the following conditions - Fan is based on High and Super-high.
 5. The operating sound measured at the point 1.5 m below the center of the unit is converted to that measured at an anechoic chamber.
 6. The specifications, designs and information here are subject to change without notice.

LZ-H015GBA6 / LZ-H020GBA6



Accessories

| CHASSIS | LZ-H015GBA6 | LZ-H020GBA6 |
|------------------------------------------|-------------|-------------|
| CO ₂ Sensor | | Embedded |
| UVano | | Embedded |
| Pre Filter (Washable) | | Embedded |
| Dual Laser Fine Dust Sensor | | Embedded |
| Remote Controller (PREMTB101 / PREMTB01) | | ○ |
| Wi-Fi Module (PWFMDD0200) | | ○ |

W/O - Applied, - Not applied
 Option - Refer to model name in table

Functions

| MODEL | LZ-H015GBA6 | LZ-H020GBA6 |
|-------------------------|--------------------------------------|-------------|
| Air Purification | UVano | ○ |
| | Pre-Filter | ○ |
| Reliability | Fine Filter (ePM, 95%) | ○ |
| | Self Diagnosis | ○ |
| Convenience | Auto Restart | ○ |
| | Child Lock* | ○ |
| | Forward Operation | ○ |
| | Group Control* | ○ |
| | Turn On / Off Reservation | ○ |
| | Schedule* | ○ |
| | Night Silent Cooling Operation | ○ |
| | Delayed Operation | ○ |
| | Air-flow Amount Customized Operation | ○ |
| | Seasonal Customized Operation | ○ |
| Seasonal Auto Operation | ○ | |
| Installation | E.S.P. Control* | ○ |
| | Central Control (LGAP) | ○ |
| ETC | Filter Alarm | ○ |
| | CO ₂ Sensor | ○ |
| | Wi-Fi | Accessory |

Note
 1. O - Applied, X - Not applied
 * Accessory - Ordered and purchased separately the accessory package referring to the model name provided and install at field.
 - Accessory line-ups varies by region, so check your local catalogue or local sales material.
 2. Some functions can be limited by remote controller.
 3.* These functions need to connect the wired remote controller